

滨州东利金属科技股份有限公司

Binzhou DONGLI Stainless Steel Products Co.,Ltd.

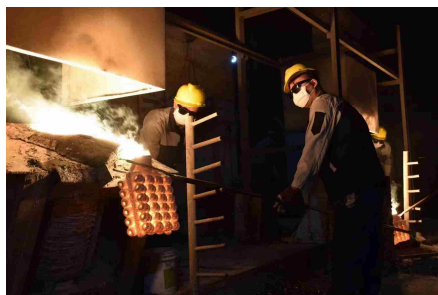

公司简介

INTRODUCTION

Binzhou Dongli Stainless Steel Products Co., LTD is a comprehensive enterprise specializing in the production, processing and surface treatment of stainless steel precision castings. Our main products are (include) Camlock couplings, threaded pipe fittings, auto parts, ball valves, rigging and various kinds of industrial coupling and accessories. Our company was founded in 2010 and has more than 130 employees, with an annual capacity of 1,200 tons of high-quality castings. The products are widely used in fire fighting, construction, fluid pipeline, Marine hardware, aerospace, auto industries, medical instruments, petrochemical and other fields.

We ensure the perfect interior and exterior quality with the silicasol lost wax casting technology, high precision CNC lathe, and equipped with advanced spectrometer, sclerometer, metallographic microscope and other equipment. The products can be produce by the material stainless steel 304/316/304L/316L/201, plain carbon steels, structural alloy steel, aluminum alloy, brass and so on. The products was exported to Europe, America, Australia, Russia, Korea, Japan and other countries and regions, received good appraises both at home and abroad.

Our company has a professional professional R&D team and complete quality control capabilities. We can also provide drawings, tooling design, mold design and development and other technical support according to customer requirement. Pre-furnace spectrum analysis, casting mechanical property testing, nondestructive testing, heat treatment hardness testing, metallographic analysis, 3D coordinate measurement of workpiece and other monitoring methods provide necessary hardware support for ensuring product quality. At the same time, the company also established a perfect quality control system, and passed ISO9001:2015 quality management system certification, TS16949:2016 quality system certification.

Our company adhering to the concept of "quality first, customer first", to meet customer needs as the goal, dedicated to the majority of customers to do a good job in service. Sincerely welcome your visit, guidance and business negotiation. Dongli Steel is looking forward to working with you to create brilliant!

滨州东利金属科技股份有限公司是一家专业从事不锈钢精密铸件生产,深加工及铸件表面处理的综合性企业,主要产品有快速接头、螺纹管件、汽车配件、球阀、索具等各种工业接口和配件。公司成立于2010年,目前拥有员工130余人,年生产规模超过1200吨。产品广泛应用于消防、建筑、流体管道、船用五金、航空航天、医疗器械、石油化工等领域。

我公司采用硅溶胶失蜡铸造工艺生产精密铸件,配备高精度CNC数控车床、加工中心进行深加工。材质涉及到不锈钢(316、316L、304、304L),普通碳钢,合金结构钢,铝合金,黄铜等。产品畅销于美国、澳大利亚、俄罗斯、德国、韩国、日本等国家和地区。

公司拥有专业的产品研发团队和完备的质量控制能力,可根据客户提供产品图纸、工装设计,模具设计开发等方面的技术支持。炉前光谱分析,铸件机械性能检测,产品无损探伤,热处理硬度检测,金相分析,加工件三维坐标测量等监控手段为确保产品质量提供了必要的硬件支持。同时,公司还建立了完善的质量监控体系,并通过了质量管理体系ISO9001:2015,TS16949:2016的质量体系认证。

公司秉承质量至上,客户至上的理念,以满足客户需求作为目标,竭诚为广大客户做好服务。真诚欢迎您莅临参观指导和业务洽谈。东利金属期待与您携手共创辉煌!

公司设备

Production Equipment

DONGLI

滨州东利金属科技股份有限公司

Binzhou DONGLI Stainless Steel Products Co.,Ltd.



生产工艺

Production Process

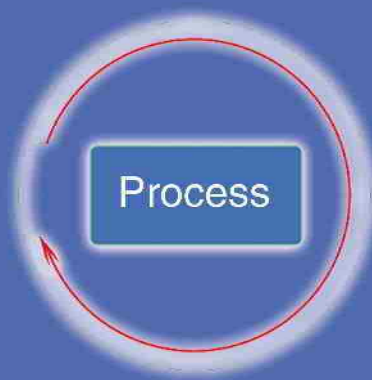

- | | | |
|--------------------|-------------------|---------------------|
| 01 Mould Making | 02 Wax Injectin | 03 Pattern Assembly |
| 04 Shelling | 05 Dewaxing | 06 Burning |
| 07 Pouring | 08 Shell Removing | 09 Cutting |
| 10 Ingate Removing | | |

1



2



3



6



5



4



7

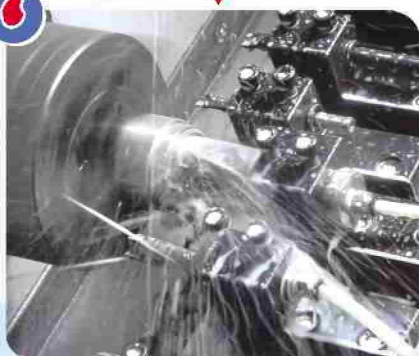

8



9





滨州东利金属科技股份有限公司
Binzhou DONGLI Stainless Steel Products Co.,Ltd.

公司资质 Company qualification



目录 CONTENT 《

Cam & Groove Couplings/Camlock Couplings	
MIL/EN/DIN	1
MIL A-A-59326 快速接头	2-4
EN14420-7/DIN2828 德式快速接头	5-7
Cam & Groove Couplings/Camlock Couplings	
Autolock Camlock Couplings 自锁式快速接头	8-9
Cam & Groove Couplings/Camlock Couplings	
Stainless Steel Camlock Reducer 不锈钢异径接头	10-11
Cam & Groove Couplings/Camlock Couplings	
Accessory 快速接头配件	12
TW Couplings/Tank Truck Couplings	
EN14420-6/DIN28450 油罐车接头	12
Hose fitting with safety clamps	
En 14420 /DIN 2817 安全夹, DIN2817接头	13-14
Pipe Fitting in Stainless Steel 不锈钢管件	15-18
Ball Valve in Stainless Steel 不锈钢球阀	19-22
Rigging in Stainless Steel 不锈钢索具	23
Ski Accessories 滑雪配件	24

Camlocks are often referred to as Cam and Groove Couplings. This is because they are engineered with grooves that allow the various styles to fit together creating a tight seal. Their simple structure and easy operation make them very popular. Camlocks are connected by simply opening the coupler arms and inserting the adaptor into the coupler. As the arms are pushed down to the sides, the two connectors are forced tightly together creating the bonded seal on an internal gasket.

Camlocks come in a variety of materials: stainless steel, aluminum, brass, polypropylene, nylon.

Standard

1. MIL A-A-59326

Cam & Groove couplings are made in compliance with A-A-59326 (old version called MIL-C-27487) specification.

2. EN14420-7 (DIN2828)

The European standard EN 14420-7:2004 replaces DIN 2828, which was applied to cam & groove couplings manufactured to A-A-59326A. A flat thread seal has been added to the female threaded parts, and a smooth hose shank has been added for assembly with DIN 2817 safety clamps.

Size

Stainless steel: 1/2" to 8"

Aluminum: 1/2" to 8"

Brass: 1/2" to 6"

PP: 1/2" to 4"

Nylon: 1/2" to 4"

Material

1. Stainless steel AISI 316/AISI 304 by investment casting

2. Aluminum by gravity casting

3. Brass CW614N by forging

4. Polypropylene

5. Nylon

Features

1. Handles are made of stainless steel AISI 304 as a standard.

2. Camlock are capable of transporting liquids, solids and gases, except liquid gas and steam.

3. Coupling with multi-serrated hose shank & collar are available on customer's request.

Gaskets Material:

- NBR
- EPDM
- Viton
- Silicon

Thread:

- NPT
- BSP (female BSPP & male BSPT)
- DIN2999



Working Pressure

Size (inch)	1/2"	3/4"-2"	2-1/2"	3"	4"- 6"
Working Pressure (PSI)	150 PSI	250 PSI	225 PSI	200 PSI	100 PSI

DongLi 2023	Name	DN	Size	N.W(KGS)
不锈钢快速接头 Type A STAINLESS STEEL CAMLOCK COUPLING Male Adapter X Female Thread 	A050SS	15	1/2"	
	A075SS	20	3/4"	
	A100SS	25	1"	
	A125SS	32	1 1/4"	
	A150SS	40	1 1/2"	
	A200SS	50	2"	
	A250SS	65	2 1/2"	
	A300SS	80	3"	
	A400SS	100	4"	
	A500SS	125	5"	
	A600SS	150	6"	
	A800SS	200	8"	
不锈钢快速接头 Type B STAINLESS STEEL CAMLOCK COUPLING Female Coupler X Male Thread 	B050SS	15	1/2"	
	B075SS	20	3/4"	
	B100SS	25	1"	
	B125SS	32	1 1/4"	
	B150SS	40	1 1/2"	
	B200SS	50	2"	
	B250SS	65	2 1/2"	
	B300SS	80	3"	
	B400SS	100	4"	
	B500SS	125	5"	
	B600SS	150	6"	
	B800SS	200	8"	
不锈钢快速接头 Type C STAINLESS STEEL CAMLOCK COUPLING Female Coupler X Hose Shank 	C050SS	15	1/2"	
	C075SS	20	3/4"	
	C100SS	25	1"	
	C125SS	32	1 1/4"	
	C150SS	40	1 1/2"	
	C200SS	50	2"	
	C250SS	65	2 1/2"	
	C300SS	80	3"	
	C400SS	100	4"	
	C500SS	125	5"	
	C600SS	150	6"	
	C800SS	200	8"	
不锈钢快速接头 Type D STAINLESS STEEL CAMLOCK COUPLING Female Coupler X Female Thread 	D050SS	15	1/2"	
	D075SS	20	3/4"	
	D100SS	25	1"	
	D125SS	32	1 1/4"	
	D150SS	40	1 1/2"	
	D200SS	50	2"	
	D250SS	65	2 1/2"	
	D300SS	80	3"	
	D400SS	100	4"	
	D500SS	125	5"	
	D600SS	150	6"	
	D800SS	200	8"	

DongLi 2023	Name	DN	Size	N.W(KGS)
不锈钢快速接头 Type E STAINLESS STEEL CAMLOCK COUPLING Male Adapter XHose Shank 	E050SS	15	1/2"	
	E075SS	20	3/4"	
	E100SS	25	1"	
	E125SS	32	1 1/4"	
	E150SS	40	1 1/2"	
	E200SS	50	2"	
	E250SS	65	2 1/2"	
	E300SS	80	3"	
	E400SS	100	4"	
	E500SS	125	5"	
	E600SS	150	6"	
	E800SS	200	8"	
不锈钢快速接头 Type F STAINLESS STEEL CAMLOCK COUPLING Male Adapter X Male Thread 	F050SS	15	1/2"	
	F075SS	20	3/4"	
	F100SS	25	1"	
	F125SS	32	1 1/4"	
	F150SS	40	1 1/2"	
	F200SS	50	2"	
	F250SS	65	2 1/2"	
	F300SS	80	3"	
	F400SS	100	4"	
	F500SS	125	5"	
	F600SS	150	6"	
	F800SS	200	8"	
不锈钢快速接头 Type DC STAINLESS STEEL CAMLOCK COUPLING Dust Cap 	DC050SS	15	1/2"	
	DC075SS	20	3/4"	
	DC100SS	25	1"	
	DC125SS	32	1 1/4"	
	DC150SS	40	1 1/2"	
	DC200SS	50	2"	
	DC250SS	65	2 1/2"	
	DC300SS	80	3"	
	DC400SS	100	4"	
	DC500SS	125	5"	
	DC600SS	150	6"	
	DC800SS	200	8"	
不锈钢快速接头 Type DP STAINLESS STEEL CAMLOCK COUPLING Dust Plug 	DP050SS	15	1/2"	
	DP075SS	20	3/4"	
	DP100SS	25	1"	
	DP125SS	32	1 1/4"	
	DP150SS	40	1 1/2"	
	DP200SS	50	2"	
	DP250SS	65	2 1/2"	
	DP300SS	80	3"	
	DP400SS	100	4"	
	DP500SS	125	5"	
	DP600SS	150	6"	
	DP800SS	200	8"	

DongLi 2023	Name	DN	Size	N.W(KGS)
不锈钢快速接头 Type SC STAINLESS STEEL CAMLOCK COUPLING Female Coupler X Serrated Hose Shank 	SC050SS	15	1/2"	
	SC075SS	20	3/4"	
	SC100SS	25	1"	
	SC125SS	32	1 1/4"	
	SC150SS	40	1 1/2"	
	SC200SS	50	2"	
	SC250SS	65	2 1/2"	
	SC300SS	80	3"	
	SC400SS	100	4"	
	SC500SS	125	5"	
	SC600SS	150	6"	
	SC800SS	200	8"	
	SE050SS	15	1/2"	
	SE075SS	20	3/4"	
	SE100SS	25	1"	
不锈钢快速接头 Type SE STAINLESS STEEL CAMLOCK COUPLING Male Adapter X Serrated Hose Shank 	SE125SS	32	1 1/4"	
	SE150SS	40	1 1/2"	
	SE200SS	50	2"	
	SE250SS	65	2 1/2"	
	SE300SS	80	3"	
	SE400SS	100	4"	
	SE500SS	125	5"	
	SE600SS	150	6"	
	SE800SS	200	8"	
	BW050SS	15	1/2"	
	BW075SS	20	3/4"	
	BW100SS	25	1"	
	BW125SS	32	1 1/4"	
	BW150SS	40	1 1/2"	
	BW200SS	50	2"	
不锈钢快速接头 Type BW STAINLESS STEEL CAMLOCK COUPLING 	BW250SS	65	2 1/2"	
	BW300SS	80	3"	
	BW400SS	100	4"	
	BW500SS	125	5"	
	BW600SS	150	6"	
	BW800SS	200	8"	
	FW050SS	15	1/2"	
	FW075SS	20	3/4"	
	FW100SS	25	1"	
	FW125SS	32	1 1/4"	
	FW150SS	40	1 1/2"	
	FW200SS	50	2"	
	FW250SS	65	2 1/2"	
	FW300SS	80	3"	
	FW400SS	100	4"	
不锈钢快速接头 Type FW STAINLESS STEEL CAMLOCK COUPLING 	FW500SS	125	5"	
	FW600SS	150	6"	
	FW800SS	200	8"	

DongLi 2023		Name	DN	Size	N.W(KGS)
德式快速接头 DIN Camlock Coupling Male Adapter X Female G	Type AF	DIN-A075SS	20	G3/4"	
		DIN-A100SS	25	G1"	
		DIN-A125SS	32	G1 1/4"	
		DIN-A150SS	40	G1 1/2"	
		DIN-A200SS	50	G2"	
		DIN-A250SS	65	G2 1/2"	
		DIN-A300SS	80	G3"	
		DIN-A400SS	100	G4"	
德式快速接头 DIN Camlock Coupling Female Coupler X Smooth Hose Shank	Type CC	DIN-C075SS	20	3/4"	
		DIN-C100SS	25	1"	
		DIN-C125SS	32	1 1/4"	
		DIN-C150SS	40	1 1/2"	
		DIN-C200SS	50	2"	
		DIN-C250SS	65	2 1/2"	
		DIN-C300SS	80	3"	
		DIN-C400SS	100	4"	
德式快速接头 DIN Camlock Coupling Female Coupler X Female G	Type DF	DIN-D075SS	20	G3/4"	
		DIN-D100SS	25	G1"	
		DIN-D125SS	32	G1 1/4"	
		DIN-D150SS	40	G1 1/2"	
		DIN-D200SS	50	G2"	
		DIN-D250SS	65	G2 1/2"	
		DIN-D300SS	80	G3"	
		DIN-D400SS	100	G4"	
德式快速接头 DIN Camlock Coupling Male Adapter X Smooth Hose Shank	Type EC	DIN-E075SS	20	3/4"	
		DIN-E100SS	25	1"	
		DIN-E125SS	32	1 1/4"	
		DIN-E150SS	40	1 1/2"	
		DIN-E200SS	50	2"	
		DIN-E250SS	65	2 1/2"	
		DIN-E300SS	80	3"	
		DIN-E400SS	100	4"	

DongLi 2023	Name	DN	Size	N.W(KGS)
德式快速接头 Type BF DIN Camlock Coupling Male Adapter X Female R	DIN-B075SS	20	G3/4"	
	DIN-B100SS	25	G1"	
	DIN-B125SS	32	G1 1/4"	
	DIN-B150SS	40	G1 1/2"	
	DIN-B200SS	50	G2"	
	DIN-B250SS	65	G2 1/2"	
	DIN-B300SS	80	G3"	
	DIN-B400SS	100	G4"	
德式快速接头 Type FF DIN Camlock Coupling Male Adapter X Male R	DIN-F075SS	20	G3/4"	
	DIN-F100SS	25	G1"	
	DIN-F125SS	32	G1 1/4"	
	DIN-F150SS	40	G1 1/2"	
	DIN-F200SS	50	G2"	
	DIN-F250SS	65	G2 1/2"	
	DIN-F300SS	80	G3"	
	DIN-F400SS	100	G4"	
德式快速接头 Type SCC DIN Camlock Coupling Female Coupler X Serrated Hose Shank	DIN-SCC075SS	20	3/4"	
	DIN-SCC100SS	25	1"	
	DIN-SCC125SS	32	1 1/4"	
	DIN-SCC150SS	40	1 1/2"	
	DIN-SCC200SS	50	2"	
	DIN-SCC250SS	65	2 1/2"	
	DIN-SCC300SS	80	3"	
	DIN-SCC400SS	100	4"	
德式快速接头 Type SEC DIN Camlock Coupling Male Adapter X Serrated Hose Shank	DIN-SEC075SS	20	3/4"	
	DIN-SEC100SS	25	1"	
	DIN-SEC125SS	32	1 1/4"	
	DIN-SEC150SS	40	1 1/2"	
	DIN-SEC200SS	50	2"	
	DIN-SEC250SS	65	2 1/2"	
	DIN-SEC300SS	80	3"	
	DIN-SEC400SS	100	4"	

DongLi 2023	Name	DN	Size	N.W(KGS)
德式快速接头 Type AW DIN Camlock Coupling 	DIN-AW075SS	20	3/4"	
	DIN-AW100SS	25	1"	
	DIN-AW125SS	32	1 1/4"	
	DIN-AW150SS	40	1 1/2"	
	DIN-AW200SS	50	2"	
	DIN-AW250SS	65	2 1/2"	
	DIN-AW300SS	80	3"	
	DIN-AW400SS	100	4"	
德式快速接头 Type DW DIN Camlock Coupling 	DIN-DW075SS	20	3/4"	
	DIN-DW100SS	25	1"	
	DIN-DW125SS	32	1 1/4"	
	DIN-DW150SS	40	1 1/2"	
	DIN-DW200SS	50	2"	
	DIN-DW250SS	65	2 1/2"	
	DIN-DW300SS	80	3"	
	DIN-DW400SS	100	4"	
德式快速接头 Type SC DIN Camlock Coupling 	DIN-SC075SS	20	3/4"	
	DIN-SC100SS	25	1"	
	DIN-SC125SS	32	1 1/4"	
	DIN-SC150SS	40	1 1/2"	
	DIN-SC200SS	50	2"	
	DIN-SC250SS	65	2 1/2"	
	DIN-SC300SS	80	3"	
	DIN-SC400SS	100	4"	
德式快速接头 Type SE DIN Camlock Coupling 	DIN-SE075SS	20	3/4"	
	DIN-SE100SS	25	1"	
	DIN-SE125SS	32	1 1/4"	
	DIN-SE150SS	40	1 1/2"	
	DIN-SE200SS	50	2"	
	DIN-SE250SS	65	2 1/2"	
	DIN-SE300SS	80	3"	
	DIN-SE400SS	100	4"	

Autolock camlock coupling was also referred to as self-locking camlock coupling. The cam arms were specially designed for the safety and convenience of connection. You can simply close the cam arms just like a regular camlock, but the cam arms lock themselves automatically with a positive click. Autolock coupling holds the adaptor more securely to the coupler to provide added protection against accidental release.

Application

The couplings are capable of transporting liquids, solids and gases, except liquid gas and steam.

Material

Stainless steel AISI316/AISI304 by investment casting

Size

Autolock camlock couplings from 1/2" to 4" are available

Seal

1. The standard flat gasket seal for the autolock camlock is NBR
2. The gasket for DIN female thread coupling according to EN 14420-5, the standard material is PTFE for stainless steel.

Features

1. Handles are made of stainless steel AISI 304 as a standard.
2. Provides extra protection against accidental release.

Thread

Camlock	Male	Female	Standard
MIL-type	NPT	NPT	NPT according to ANSI/ASME B1.20.1
DIN-type	BSPT	BSP	BSP according to EN ISO 228-1

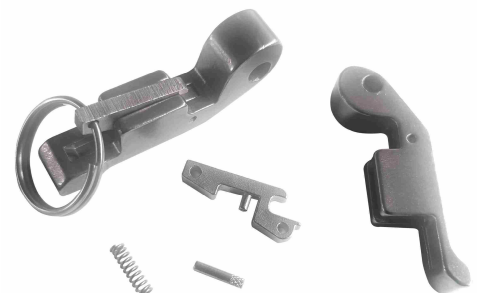

(19) 中华人民共和国国家知识产权局



(12) 实用新型专利

(10) 授权公告号 CN 204677943 U
(45) 授权公告日 2015.09.30

(21) 申请号 201320329835.1

(22) 申请日 2013.05.21

(73) 专利权人 滨州东利不锈钢制品有限公司
地址 256600 山东省滨州市无棣县小泊头镇人民政府驻地

(72) 发明人 全林东

(74) 专利代理机构 北京科亿知识产权代理事务
所(普通合伙) 11350

代理人 汤东风

(51) Int. Cl.
F16L 37/16(2006.01)

权利要求书1页 说明书2页 附图1页

(54) 实用新型名称

一种凸轮式快速连接装置

(57) 摘要

本实用新型公开了一种凸轮式快速连接装置,属于不锈钢制品加工制造专业技术领域。其特征在于:还包括自锁机构,同一侧的两个耳板下端面设有底座,底座上设有自锁孔,锁紧臂内端设有凸块,所述自锁机构包括自锁臂、弹簧和护板,所述护板为两个,两护板之间形成凹腔,所述自锁机构置于凹腔内,所述锁紧臂与自锁臂上设锁销连接,所述弹簧一端与锁紧臂连接,另一端与自锁臂固定连接,与现有技术相比较具有结构简单,生产加工方便,成本低,使用效果明显,便于广泛的推广和使用的特点。

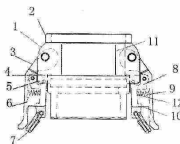

DongLi 2016	Name	DN	Size	N.W(KGS)
不锈钢自锁式接头 Type B SELF-LOCKING CAMLOCK Type B With Self-locking Handles	AUTB050SS	15	1/2"	
	AUTB075SS	20	3/4"	
	AUTB100SS	25	1"	
	AUTB125SS	32	1 1/4"	
	AUTB150SS	40	1 1/2"	
	AUTB200SS	50	2"	
	AUTB250SS	65	2 1/2"	
	AUTB300SS	80	3"	
	AUTB400SS	100	4"	
不锈钢自锁式接头 Type C SELF-LOCKING CAMLOCK Type C With Self-locking Handles	AUTC050SS	15	1/2"	
	AUTC075SS	20	3/4"	
	AUTC100SS	25	1"	
	AUTC125SS	32	1 1/4"	
	AUTC150SS	40	1 1/2"	
	AUTC200SS	50	2"	
	AUTC250SS	65	2 1/2"	
	AUTC300SS	80	3"	
	AUTC400SS	100	4"	
不锈钢自锁式接头 Type D SELF-LOCKING CAMLOCK Type D With Self-locking Handles	AUTD050SS	15	1/2"	
	AUTD075SS	20	3/4"	
	AUTD100SS	25	1"	
	AUTD125SS	32	1 1/4"	
	AUTD150SS	40	1 1/2"	
	AUTD200SS	50	2"	
	AUTD250SS	65	2 1/2"	
	AUTD300SS	80	3"	
	AUTD400SS	100	4"	
不锈钢自锁式接头 Type DC SELF-LOCKING CAMLOCK Type DC With Self-locking Handles	AUTDC050SS	15	1/2"	
	AUTDC075SS	20	3/4"	
	AUTDC100SS	25	1"	
	AUTDC125SS	32	1 1/4"	
	AUTDC150SS	40	1 1/2"	
	AUTDC200SS	50	2"	
	AUTDC250SS	65	2 1/2"	
	AUTDC300SS	80	3"	
	AUTDC400SS	100	4"	



不锈钢异径接头

STAINLESS STEEL CAMLOCK REDUCER

SA,DD,DA,DCL,LC,AR,BR,CR,DR,ER,FR,FA&FC,90°C

Type AA SPOOL ADAPTER Male Adapter X Male Adapter



SIZE	PART#
1"x1"	AA100-SS
1-1/4"x1-1/4"	AA125-SS
1-1/2"	AA150-SS
1-1/2"x2"	AA1520-SS
2"x2"	AA200-SS
2-1/2"	AA250-SS
2"x2-1/2"	AA2025-SS
2"x3"	AA2030-SS
3"x3"	AA300-SS
3"x4"	AA3040-SS
4"x4"	AA400-SS
4"x6"	AA4060-SS
6"x6"	AA600-SS

Type DD SPOOL COUPLER Female Coupler X Female Coupler

SIZE	PART#
1" X1"	DD100-SS
1-1/2" X 1-1/2"	DD150-SS
2" X 2"	DD200-SS
3" X 3"	DD300-SS
3" X 2"	DD3020-SS
4" X 4"	DD400-SS
4" X 3"	DD4030-SS



Type DA D & A TYPE REDUCER Female Coupler X Male Adapter



SIZE	PART#
1-1/2"x1"	DA1510-SS
1-1/2"x2"	DA1520-SS
2"x1-1/2"	DA2015-SS
2"x3"	DA2030-SS
2"x4"	DA2040-SS
3"x1-1/2"	DA3015-SS
3"x2"	DA3020-SS
3"x2-1/2"	DA3025-SS
3"x4"	DA3040-SS
4"x2"	DA4020-SS
4"x3"	DA4030-SS
4"x6"	DA4060-SS
6"x4"	DA6040-SS

Type DCL LOCKABLE DUST CAP DC WITH "L" TYPE HANDLE

SIZE	PART#
1"	DCL100-SS
1-1/4"	DCL125-SS
1-1/2"	DCL150-SS
2"	DCL200-SS
3"	DCL300-SS
4"	DCL400-SS
6"	DCL600-SS



Type LC Composite camlock coupling

SIZE	PART#
1"	C100-SS
1.5"	C150-SS
2"	C200-SS
3"	C300-SS
4"	C400-SS



Type AR A TYPE REDUCER
Male Adapter X Female Thread



SIZE	PART#
1-1/2"X2"	AR1520-SS
2"X1-1/2"	AR2015-SS
2"X3"	AR2030-SS
3"X2"	AR3020-SS
3"X4"	AR3040-SS
4"X3"	AR4030-SS
4"X6"	AR4060-SS
6"X4"	AR6040-SS

Type BR B TYPE REDUCER
Female Coupler X Male Thread



SIZE	PART#
1-1/2"X1"	BR1510-SS
2"X1-1/2"	BR2015-SS
3"X2"	BR3020-SS
3"X4"	BR3040-SS
4"X3"	BR4030-SS

Type CR C TYPE REDUCER
Female Coupler X Hose Shank



SIZE	PART#
3/4"X1-1/2"	CR7550-SS
1"X3/4"	CR1075-SS
2"X1-1/2"	CR2015-SS
3"X2"	CR3020-SS
3"X4"	CR3040-SS
4"X3"	CR4030-SS

Type DR D TYPE REDUCER
Female Coupler X Female Thread



SIZE	PART#
1-1/2"X1"	DR1510-SS
2"X1-1/2"	DR2015-SS
3"X2"	DR3020-SS
4"X3"	DR4030-SS

Type ER E TYPE REDUCER
Male Adapter X Hose Shank



SIZE	PART#
3/4"X1-1/2"	ER7550-SS
1"X3/4"	ER1075-SS
2"X1-1/2"	ER2015-SS
2"X3"	ER2030-SS
3"X2"	ER3020-SS
3"X4"	ER3040-SS
4"X2"	ER4020-SS
4"X3"	ER4030-SS

Type FR F TYPE REDUCER
Male Adapter X Male Thread



SIZE	PART#
2"X1-1/2"	FR2015-SS
2"X3"	FR2030-SS
3"X1-1/2"	FR3015-SS
3"X2"	FR3020-SS
3"X4"	FR3040-SS
4"X3"	FR4030-SS
4"X6"	FR4060-SS

90°C TYPE 90°C
90° Coupler X Hose Shank



SIZE	PART#
1"	90ELC100
1-1/4"	90ELC125
1-1/2"	90ELC150
2"	90ELC200
3"	90ELC300
4"	90ELC400
6"	90ELC600

FA & FC TYPE FA & FC
CAM & GROOVE FLANGE COUPLING



SIZE	PART#
1"	FA100& FC100
1-1/2"	FA150& FC150
2"	FA200 & FC200
3"	FA300 & FC300
4"	FA400 & FC400
5"	FA500 & FC500
6"	FA600 & FC600

Gasket

NBR, EPDM, Viton, Silicone

DongLi 2016	SIZE	Name
	1/2"	SE050-SS
	3/4"	SE075-SS
	1"	SE100-SS
	1-1/4"	SE125-SS
	1-1/2"	SE150-SS
	2"	SE200-SS
	2-1/2"	SE250-SS
	3"	SE300-SS
	4"	SE400-SS
	5"	SE500-SS
	6"	SE600-SS
	8"	SE800-SS



L Type Handles

Handles

Camlock Handles

DongLi 2016	Name	SIZE
	H050-SS	1/2"-3/4"
	H100-SS	1"
	H200-SS	1-1/4"-2-1/2"
	H300-SS	3"-4"
	H600-SS	6"

PIN

Camlock PIN

DongLi 2016	Name	SIZE
	H050-SS	1/2"-3/4"
	H100-SS	1"
	H200-SS	1-1/4"-2-1/2"
	H300-SS	3"-4"
	H600-SS	6"

TW Couplings/Tank Truck Couplings (EN14420-6/DIN28450)

油罐车接头

TW COUPLINGS - DIN28450

TW COUPLINGS

TANK TRUCK COUPLING
DIN28450



Standard:

- DIN28450

Material:

- Stainless Steel 304 316

SIZE:

- From: DN50~DN100

TYPE:

- VK+MK+VB+MB+HYPALON GASKET

Part #:

- TW50-TW100



Hose fitting with safety clamps En 14420 /DIN 2817

Dongli hose fitting with safety clamps are produced to EN14420. It contains DIN 2817 hose fitting and DIN 2817 safety clamps.
Hose fitting with male pipe thread (GA) have a smooth or serrated hose tail with a collar.
Hose fitting with union nut (GI) have a smooth or serrated tail, assembled with a nut by a sealing ring.
Safety clamps are produced to EN14420-3, size from DN13 to DN100.

Application

DIN 2817 fitting & safety clamp are used for chemical, food and drink, petrochemicals, airport refuelling, liquefied gas, etc.

Material for GA/GI

Stainless steel AISI316/AISI304 by investment casting

Features

- Standards:
Safety clamps comply to standard of EN14420-3
Hose fitting GA/GI comply to standard of EN14420-5
- Size:
Safety clamps available from DN13 to DN150
Hose fitting GA/GI available from 1/2" to 4"



Hose fitting with safety clamps EN 14420/DIN 2817 Safe Clamps EN 14420-3

with bolt and nut
stainless steel

安全夹







Name	Bolt&Nut	Hose OD min-Max/mm
DN13*5SS	4*M6*20	22-24
DN19*6SS	4*M6*20	30-33
DN25*6SS	4*M6*20	36-39
DN32*6SS	4*M6*20	43-46
DN38*6.5SS	4*M6*20	50-52
DN50*8SS	4*M8*25	64-67
DN63*8SS	4*M8*25	78-82
DN75*8SS	4*M8*25	89-94
DN100*8SS	4*M10*40	114-119
DN150*10SS	4*M12*50	167-173

Material and Standard for Bolts & Nuts



Bolts	Zinc plated 8.8	EN IOS 4762
	Stainless steel 304	
Nut	Zinc plated 8	EN IOS 4032
	Stainless steel 304	

DongLi 2023	Name	DN	Thread	Tail mm
GI with smooth tail in stainless steel 	GI015SS	15	G1/2"	13.4
	GI020SS	20	G3/4"	19.4
	GI025SS	25	G1"	25.4
	GI032SS	32	G1 1/4"	32.4
	GI040SS	40	G1 1/2"	38.4
	GI050SS	50	G2"	50.4
	GI065SS	65	G2 1/2"	63.2
	GI075SS	80	G3"	75.4
	GI100SS	100	G4"	100.3
GA with smooth tail in stainless steel 	GA015SS	15	G1/2"	13.4
	GA020SS	20	G3/4"	19.4
	GA025SS	25	G1"	25.4
	GA032SS	32	G1 1/4"	32.4
	GA040SS	40	G1 1/2"	38.4
	GA050SS	50	G2"	50.4
	GA065SS	65	G2 1/2"	63.2
	GA075SS	80	G3"	75.4
	GA100SS	100	G4"	100.3
GI with serrated tail in stainless steel 	GIS015SS	15	G1/2"	13.4
	GIS020SS	20	G3/4"	19.4
	GIS025SS	25	G1"	25.4
	GIS032SS	32	G1 1/4"	32.4
	GIS040SS	40	G1 1/2"	38.4
	GIS050SS	50	G2"	50.4
	GIS065SS	65	G2 1/2"	63.2
	GIS075SS	80	G3"	75.4
	GIS100SS	100	G4"	100.3
GA with serrated tail in stainless steel 	GAS015SS	15	G1/2"	13.4
	GAS020SS	20	G3/4"	19.4
	GAS025SS	25	G1"	25.4
	GAS032SS	32	G1 1/4"	32.4
	GAS040SS	40	G1 1/2"	38.4
	GAS050SS	50	G2"	50.4
	GAS065SS	65	G2 1/2"	63.2
	GAS075SS	80	G3"	75.4
	GAS100SS	100	G4"	100.3



150LB Stainless steel pipe fittings are ideal for use in many systems such as those handling compressed air, chemicals, hot or cold water, process steam and more. Our stainless steel fittings are mainly BSP threaded (BSPT taper male/BSPP parallel female) and rated for up to 20 bar (150 PSI) pressure dependent on temperature. Other type of thread is also available on request.

DongLi 2023	Name	SIZE
90°Elbow F-F	ELB90/6SS	1/8"
	ELB90/8SS	1/4"
	ELB90/10SS	3/8"
	ELB90/15SS	1/2"
	ELB90/20SS	3/4"
	ELB90/25SS	1"
	ELB90/32SS	1 1/4"
	ELB90/40SS	1 1/2"
	ELB90/50SS	2"
	ELB90/65SS	2 1/2"
	ELB90/80SS	3"
	ELB90/100SS	4"



DongLi 2023	Name	SIZE
45°Elbow F-F	ELB45/6SS	1/8"
	ELB45/8SS	1/4"
	ELB45/10SS	3/8"
	ELB45/15SS	1/2"
	ELB45/20SS	3/4"
	ELB45/25SS	1"
	ELB45/32SS	1 1/4"
	ELB45/40SS	1 1/2"
	ELB45/50SS	2"
	ELB45/65SS	2 1/2"
	ELB45/80SS	3"
	ELB45/100SS	4"



DongLi 2016	Name	SIZE
Cross F-F-F-F	CRO6SS	1/8"
	CRO8SS	1/4"
	CRO10SS	3/8"
	CRO15SS	1/2"
	CRO20SS	3/4"
	CRO25SS	1"
	CRO32SS	1 1/4"
	CRO40SS	1 1/2"
	CRO50SS	2"
	CRO65SS	2 1/2"
	CRO80SS	3"
	CRO100SS	4"



DongLi 2023	Name	SIZE
Tees	TEE6SS	1/8"
	TEE8SS	1/4"
	TEE10SS	3/8"
	TEE15SS	1/2"
	TEE20SS	3/4"
	TEE25SS	1"
	TEE32SS	1 1/4"
	TEE40SS	1 1/2"
	TEE50SS	2"
	TEE65SS	2 1/2"
	TEE80SS	3"
	TEE100SS	4"



DongLi 2023	Name	SIZE
Socket Banded F-F	SOBA6SS	1/8"
	SOBA8SS	1/4"
	SOBA10SS	3/8"
	SOBA15SS	1/2"
	SOBA20SS	3/4"
	SOBA25SS	1"
	SOBA32SS	1 1/4"
	SOBA40SS	1 1/2"
	SOBA50SS	2"
	SOBA65SS	2 1/2"
	SOBA80SS	3"
	SOBA100SS	4"



DongLi 2023	Name	SIZE
Square Plug M	SQP6SS	1/8"
	SQP8SS	1/4"
	SQP10SS	3/8"
	SQP15SS	1/2"
	SQP20SS	3/4"
	SQP25SS	1"
	SQP32SS	1 1/4"
	SQP40SS	1 1/2"
	SQP50SS	2"
	SQP65SS	2 1/2"
	SQP80SS	3"
	SQP100SS	4"



DongLi 2023	Name	SIZE
Hex Cap F	HXHC6SS	1/8"
	HXHC8SS	1/4"
	HXHC10SS	3/8"
	HXHC15SS	1/2"
	HXHC20SS	3/4"
	HXHC25SS	1"
	HXHC32SS	1 1/4"
	HXHC40SS	1 1/2"
	HXHC50SS	2"
	HXHC65SS	2 1/2"
	HXHC80SS	3"
	HXHC100SS	4"



DongLi 2023	Name	SIZE
90° Elbow F-M	STEB6SS	1/8"
	STEB8SS	1/4"
	STEB10SS	3/8"
	STEB15SS	1/2"
	STEB20SS	3/4"
	STEB25SS	1"
	STEB32SS	1 1/4"
	STEB40SS	1 1/2"
	STEB50SS	2"
	STEB65SS	2 1/2"
	STEB80SS	3"
	STEB100SS	4"



DongLi 2023	Name	SIZE
Hose Nipple M	HON6SS	1/8"
	HON8SS	1/4"
	HON10SS	3/8"
	HON15SS	1/2"
	HON20SS	3/4"
	HON25SS	1"
	HON32SS	1 1/4"
	HON40SS	1 1/2"
	HON50SS	2"
	HON65SS	2 1/2"
	HON80SS	3"
	HON100SS	4"



DongLi 2023	Name	SIZE
Hex Nipple M-M	HXNP6SS	1/8"
	HXNP8SS	1/4"
	HXNP10SS	3/8"
	HXNP15SS	1/2"
	HXNP20SS	3/4"
	HXNP25SS	1"
	HXNP32SS	1 1/4"
	HXNP40SS	1 1/2"
	HXNP50SS	2"
	HXNP65SS	2 1/2"
	HXNP80SS	3"
	HXNP100SS	4"



DongLi 2023	Name	SIZE
Hex Nut F	HXNT6SS	1/8"
	HXNT8SS	1/4"
	HXNT10SS	3/8"
	HXNT15SS	1/2"
	HXNT20SS	3/4"
	HXNT25SS	1"
	HXNT32SS	1 1/4"
	HXNT40SS	1 1/2"
	HXNT50SS	2"
	HXNT65SS	2 1/2"
	HXNT80SS	3"
	HXNT100SS	4"



DongLi 2023	Name	SIZE
Union F-M	UNMF6SS	1/8"
	UNMF8SS	1/4"
	UNMF10SS	3/8"
	UNMF15SS	1/2"
	UNMF20SS	3/4"
	UNMF25SS	1"
	UNMF32SS	1 1/4"
	UNMF40SS	1 1/2"
	UNMF50SS	2"
	UNMF65SS	2 1/2"
	UNMF80SS	3"
	UNMF100SS	4"



DongLi 2023	Name	SIZE
Unions F-F	UNFF6SS	1/8"
	UNFF8SS	1/4"
	UNFF10SS	3/8"
	UNFF15SS	1/2"
	UNFF20SS	3/4"
	UNFF25SS	1"
	UNFF32SS	1 1/4"
	UNFF40SS	1 1/2"
	UNFF50SS	2"
	UNFF65SS	2 1/2"
	UNFF80SS	3"
	UNFF100SS	4"





DongLi 2023	Name	SIZE
Welding-Hex Nipple BW-M	WDNP6SS	1/8"
	WDNP8SS	1/4"
	WDNP10SS	3/8"
	WDNP15SS	1/2"
	WDNP20SS	3/4"
	WDNP25SS	1"
	WDNP32SS	1 1/4"
	WDNP40SS	1 1/2"
	WDNP50SS	2"
	WDNP65SS	2 1/2"
	WDNP80SS	3"
	WDNP100SS	4"





DongLi 2023	Name	SIZE
	BANP6SS	1/8"
	BANP8SS	1/4"
	BANP10SS	3/8"
	BANP15SS	1/2"
	BANP20SS	3/4"
	BANP25SS	1"
	BANP32SS	1 1/4"
	BANP40SS	1 1/2"
	BANP50SS	2"
	BANP65SS	2 1/2"
	BANP80SS	3"
	BANP100SS	4"

DongLi 2023	Name	SIZE
	SOM6SS	1/8"
	SOM8SS	1/4"
	SOM10SS	3/8"
	SOM15SS	1/2"
	SOM20SS	3/4"
	SOM25SS	1"
	SOM32SS	1 1/4"
	SOM40SS	1 1/2"
	SOM50SS	2"
	SOM65SS	2 1/2"
	SOM80SS	3"
	SOM100SS	4"

DongLi 2023	Name	SIZE
	YTHJ6SS	1/8"
	YTHJ8SS	1/4"
	YTHJ10SS	3/8"
	YTHJ15SS	1/2"
	YTHJ20SS	3/4"
	YTHJ25SS	1"
	YTHJ32SS	1 1/4"
	YTHJ40SS	1 1/2"
	YTHJ50SS	2"
	YTHJ65SS	2 1/2"
	YTHJ80SS	3"
	YTHJ100SS	4"

DongLi 2023	Name	SIZE
	RUCF6SS	1/8"
	RUCF8SS	1/4"
	RUCF10SS	3/8"
	RUCF15SS	1/2"
	RUCF20SS	3/4"
	RUCF25SS	1"
	RUCF32SS	1 1/4"
	RUCF40SS	1 1/2"
	RUCF50SS	2"
	RUCF65SS	2 1/2"
	RUCF80SS	3"
	RUCF100SS	4"

DongLi 2023	Name	SIZE
	STPM6SS	1/8"
	STPM8SS	1/4"
	STPM10SS	3/8"
	STPM15SS	1/2"
	STPM20SS	3/4"
	STPM25SS	1"
	STPM32SS	1 1/4"
	STPM40SS	1 1/2"
	STPM50SS	2"
	STPM65SS	2 1/2"
	STPM80SS	3"
	STPM100SS	4"

DongLi 2023	Name	SIZE
	HBMF6SS	1/8"
	HBMF8SS	1/4"
	HBMF10SS	3/8"
	HBMF15SS	1/2"
	HBMF20SS	3/4"
	HBMF25SS	1"
	HBMF32SS	1 1/4"
	HBMF40SS	1 1/2"
	HBMF50SS	2"
	HBMF65SS	2 1/2"
	HBMF80SS	3"
	HBMF100SS	4"

DongLi 2023	Name	SIZE
	UNFF6SS	1/8"
	UNFF8SS	1/4"
	UNFF10SS	3/8"
	UNFF15SS	1/2"
	UNFF20SS	3/4"
	UNFF25SS	1"
	UNFF32SS	1 1/4"
	UNFF40SS	1 1/2"
	UNFF50SS	2"
	UNFF65SS	2 1/2"
	UNFF80SS	3"
	UNFF100SS	4"

DongLi 2023	Name	SIZE
	WDNP6SS	1/8"
	WDNP8SS	1/4"
	WDNP10SS	3/8"
	WDNP15SS	1/2"
	WDNP20SS	3/4"
	WDNP25SS	1"
	WDNP32SS	1 1/4"
	WDNP40SS	1 1/2"
	WDNP50SS	2"
	WDNP65SS-NPT	2 1/2"
	WDNP80SS	3"
	WDNP100SS	4"

DongLi 2023	Name	SIZE
ButWeldedUnion	BWDN6SS	1/8"
	BWDN8SS	1/4"
	BWDN10SS	3/8"
	BWDN15SS	1/2"
	BWDN20SS	3/4"
	BWDN25SS	1"
	BWDN32SS	1 1/4"
	BWDN40SS	1 1/2"
	BWDN50SS	2"
	BWDN65SS	2 1/2"
	BWDN80SS	3"
	BWDN100SS	4"



DongLi 2023	Name	SIZE
Union BW.F	UBF6SS	1/8"
	UBF8SS	1/4"
	UBF10SS	3/8"
	UBF15SS	1/2"
	UBF20SS	3/4"
	UBF25SS	1"
	UBF32SS	1 1/4"
	UBF40SS	1 1/2"
	UBF50SS	2"
	UBF65SS	2 1/2"
	UBF80SS	3"
	UBF100SS	4"



DongLi 2023	Name	SIZE
Reducing Socket F-F	RSOF6SS	1/8"
	RSOF8SS	1/4"
	RSOF10SS	3/8"
	RSOF15SS	1/2"
	RSOF20SS	3/4"
	RSOF25SS	1"
	RSOFU32SS	1 1/4"
	RSOF40SS	1 1/2"
	RSOF50SS	2"
	RSOF65SS	2 1/2"
	RSOF80SS	3"
	RSOF100SS	4"



DongLi 2023	Name	SIZE
T-Type Hose Joint	THOJ6SS	1/8"
	THOJ8SS	1/4"
	THOJ10SS	3/8"
	THOJ15SS	1/2"
	THOJ20SS	3/4"
	THOJ25SS	1"
	THOJ32SS	1 1/4"
	THOJ40SS	1 1/2"
	THOJ50SS	2"
	THOJ65SS	2 1/2"
	THOJ80SS	3"
	THOJ100SS	4"



DongLi 2023	Name	SIZE
Tee Type-Y F-F-F	TPYF6SS	1/8"
	TPYF8SS	1/4"
	TPYF10SS	3/8"
	TPYF15SS	1/2"
	TPYF20SS	3/4"
	TPYF25SS	1"
	TPYF32SS	1 1/4"
	TPYF40SS	1 1/2"
	TPYF50SS	2"
	TPYF65SS	2 1/2"
	TPYF80SS	3"
	TPYF100SS	4"



DongLi 2023	Name	SIZE
Tee M-F-M	TMFM6SS	1/8"
	TMFM8SS	1/4"
	TMFM10SS	3/8"
	TMFM15SS	1/2"
	TMFM20SS	3/4"
	TMFM25SS	1"
	TMFM32SS	1 1/4"
	TMFM40SS	1 1/2"
	TMFM50SS	2"
	TMFM65SS	2 1/2"
	TMFM80SS	3"
	TMFM100SS	4"



DongLi 2023	Name	SIZE
Hose Nipple F	HNPF6SS	1/8"
	HNPF8SS	1/4"
	HNPF10SS	3/8"
	HNPF15SS	1/2"
	HNPF20SS	3/4"
	HNPF25SS	1"
	HNPF32SS	1 1/4"
	HNPF40SS	1 1/2"
	HNPF50SS	2"
	HNPF65SS	2 1/2"
	HNPF80SS	3"
	HNPF100SS	4"



DongLi 2023	Name	SIZE
Hex Adaptor F-M	HAFM6SS	1/8"
	HAFM8SS	1/4"
	HAFM10SS	3/8"
	HAFM15SS	1/2"
	HAFM20SS	3/4"
	HAFM25SS	1"
	HAFM32SS	1 1/4"
	HAFM40SS	1 1/2"
	HAFM50SS	2"
	HAFM65SS-NPT	2 1/2"
	HAFM80SS	3"
	HAFM100SS	4"



1-PC BALL VALVE 800PSI/1000PSI

Model: BT-1R

Size: 1/4"~4" REDUCED BORE(800PSI/1000PSI)

Threaded:BSPT.BSP.NPT.DIN2999.ISO228/1

Materials:CF8M(SS316),CF8(SS304)

Features:

- Investment casting body
- Working pressure 800/1000PSI for W.O.G.
- Adjustable stem packing
- Pure teflon seals and seats
- Temperature range:-60 to 450° F
- Blow-out proof stem,and safe pressure-reducing hole
- 100% leakage tested at 100PSI air under water
- Hvdrostatic test pressure:1500PSI
- Locking device(optional)

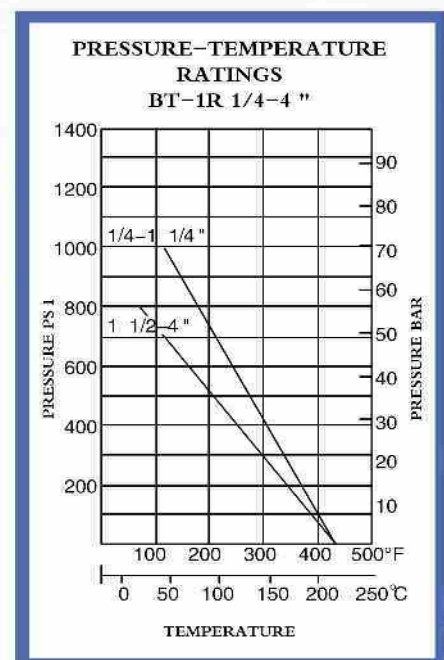
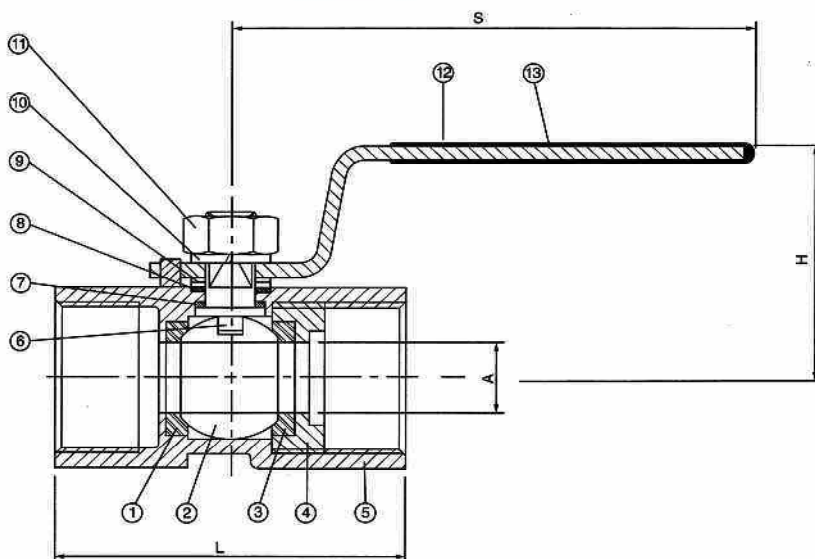

MATERIAL LIST

NO.	1	2	3	4	5	6	7	8	9	10	11	12	13
PARTS NAME	SEAT	BALL	JOINT GASKET	BODY INSERT	BODY	STEM	THRUST WASHER	STEM PACKING	GLAND NUT	STEM WASHER	STEM NUT	PLASTIC SLEEVE	HANDLE
MATERIAL	PTFE	316/304	PTFE	CF8M	CF8M	316	PTFE	PTFE	304	304	304	PVC	SS 304
Q'TY	1	1	1	1	1	1	1	1	1	1	1	1	1

2PC LIGHT DUTY BALL VALVE 1000PSI

Model: BTL-2F

Size: 1/4"~4" FULL BORE(1000PSI)

Threaded: BSPT.BSP.NPT.DIN2999.ISO228/1

Materials: CF8M(SS316), CF8(SS304)



Features:

- Investment casting body
- Working pressure 1000PSI for W.O.G.
- Adjustable stem packing
- Pure teflon seals and seats
- Temperature range: -60 to 450° F
- Blow-out proof stem and safe pressure-reducing hole
- 100% leakage tested at 100PSI air under water
- Hydrostatic test pressure: 1500PSI
- Locking device(optional)

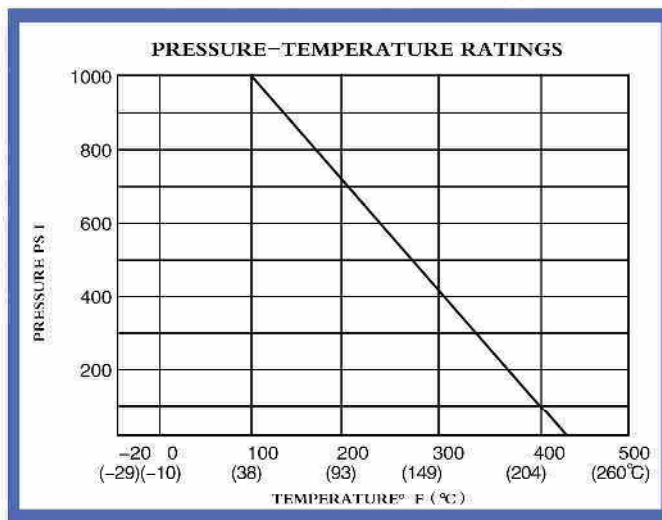
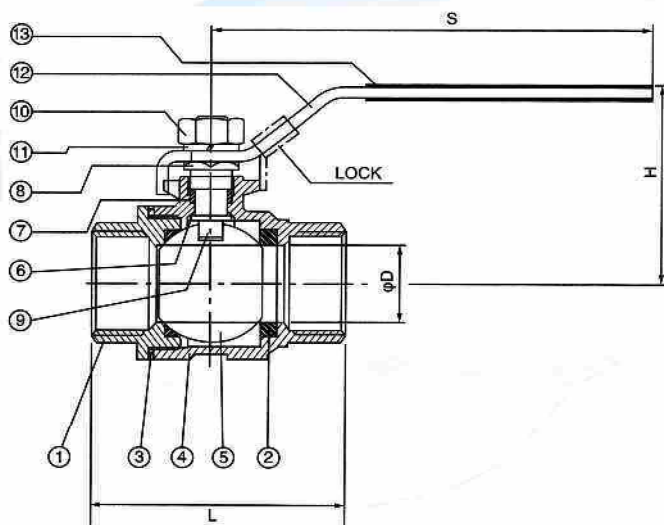

MATERIAL LIST

NO.	1	2	3	4	5	6	7	8	9	10	11	12	13
PARTS NAME	CAP	BALL SEAT	JOINT GASKET	BODY	BALL	THRUST WASHER	STEM PACKING	GLAND NUT	STEM	STEM NUT	SPRING WASHR	HANDLE	PLASTIC SLEEVE
MATERIAL	316	PTFE	PTFE	316	316	PTFE	PTFE	304	316	304	304	304	PVC
QTY	1	2	1	1	1	1	1	1	1	1	1	1	1

3PC BALL VALVE(THREADED) 1000PSI

Model: BT-3F

Size: 1/4"~4" FULL BORE(1000PSI)

Threaded:BSPT.BSP.NPT.DIN2999.ISO 228/1

Materials:CF8M(SS316),CF8(SS304)



Features:

- Investment casting body
- Working pressure 1/4 "~2" 1000PSI, 1/2 "~4" 800PSI
- Adjustable stem packing
- Pure teflon seals and seats
- Temperature range:-60 to 450° F
- Blow-out proof stem
- 100% leakage tested at 100PSI air under water
- Hvdrostatic test pressure:
1/4 "~2" 1500PSI,1/2 "~4" 1200PSI
- Locking device(optional)

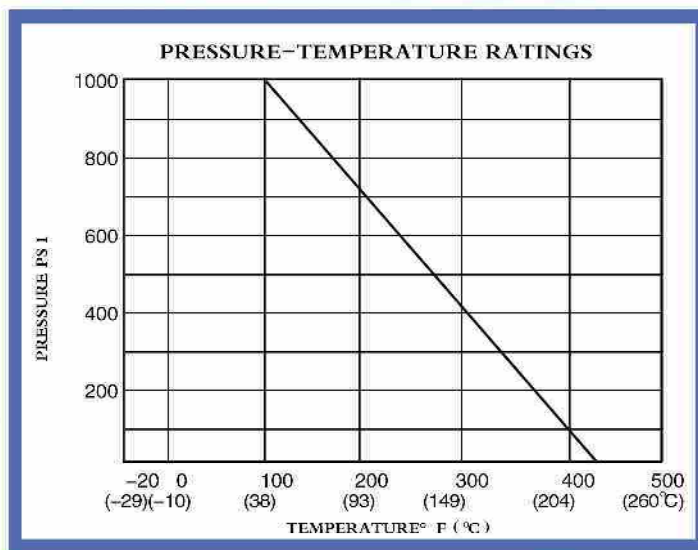
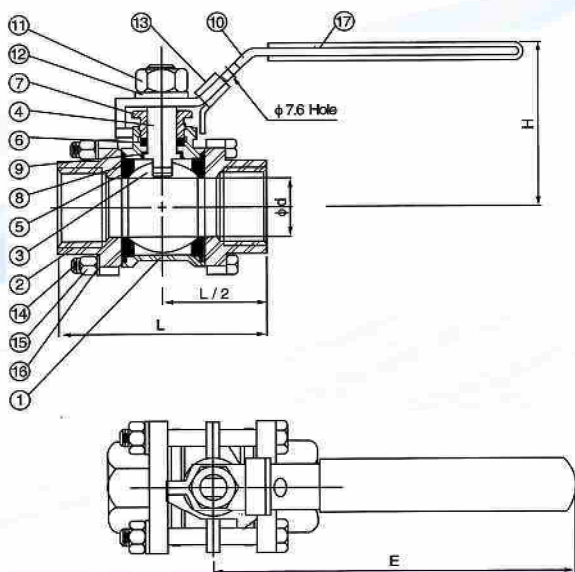

MATERIAL LIST

NO.	1	2	3	4	5	6	7	8	9
PARTS NAME	BODY	SEAT	BALL	JOINT GASKET	CAP	THRUST WASHER	STEM PACKING	STEM	GLAND NUT
MATERIAL	316	PTFE	316	PTFE	316	PTFE	PTFE	304	304
Q'TY	1	2	1	1	1	1	1	4	8

CHECK VALVE 200PSI

Model: CT-200

Size: 1/2"~2" (ANSI 200PSI)

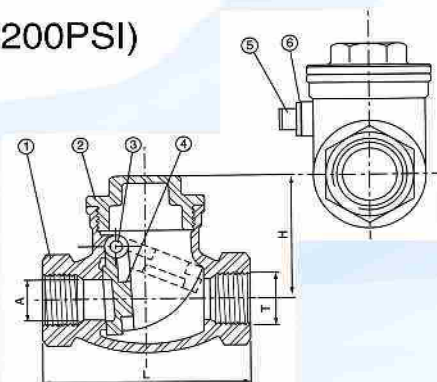

- Materials: CF8M(SS316), CF8(SS304)
- Investment casting body
- Inside screw and screwed cap
- Adjustable stem packing
- Swing type disc, integral seat

Standard:

- Full port pressure temperature rating 200 PSI WOG/350 S.P.
- Threaded ends conform to BSP.NPT.BSPT.DIN2999

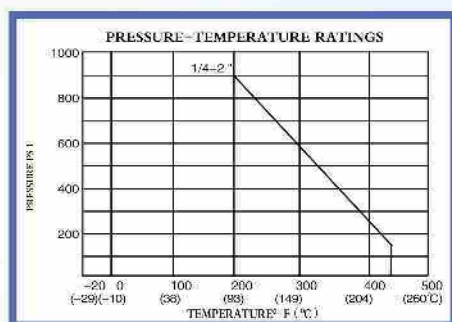

MATERIAL LIST

NO.	1	2	3	4	5	6
PART NAME	BODY	COVER	HANDLE PIN	DISC	PLUG	PLUG GASKET
SPECIFICATION	ASTM A-351 GR.CF8M	ASTM A-351 GR.CF8M	SS316	ASTM A-351 GR.CF8M	SS316	TEFLON
Q'TY	1	2	1	1	1	1

Y-STRAINER 800PSI

Model: YST-800

Size: 1/2"~2" (ANSI 800PSI)

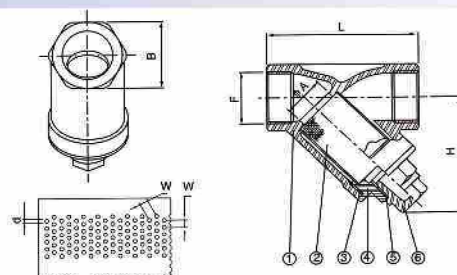

Standard:

- The end-to-end thread conforms to BSP. NPT.BSPT.DIN259,2999
- Materials: CF8M(SS316), CF8(SS304)
- Investment casting body 800PSI
- Max pressure 800PSI, maximum working temperature 230°C

MATERIAL LIST

NO.	1	2	3	4	5	6
PART NAME	BODY	SCREEN	GASKET	BONNET	O-RING	BLOW OFF
MATERIAL	ASTM A-351 GR.CF8M	SUS 316	TEFLON	ASTM A-351 GR.CF8M	VITON	ASTM A-351 GR.CF8M

不锈钢索具

Stainless steel rigging



滑雪配件

ski accessories

高压水带，内衬tpu聚氨酯，外层编制涤纶纱，工作压力6Mpa，爆破压力18Mpa，编制层外有tpu聚氨酯涂层。扣压快速接头，材质7075航空铝，T6处理，CNC加工，采用内扣压方式连接。符合AA59326标准。

High-pressure water belt, inner lining TPU, outer coating polyester yarn, working pressure 6 mpa, blasting pressure 18 mpa, TPU coating outside the coating. Fastening joint, material 7075 aviation aluminum, T6 processing, CNC machining, using internal fastening connection. Comply with AA59326 standard.



DONGLI

DONGLI CASTING is recognized as the premier manufacturer and supplier of hose fittings and accessories spanning a wide range of industrial uses. DONGLI range includes products for food, dairy processing, beverage and brewery, mobile tankers, mining, construction, chemical processing, petroleum, oilfields, refining and manufacturing.

<http://www.cndongliss.com>



炼百年不锈 铸绿色未来

Smelting century stainless Casting a green future





不断技术创新 专业引领行业

CONTINUOUS TECHNOLOGICAL INNOVATION
PROFESSIONAL TO LEAD THE INDUSTRY

滨州东利金属科技股份有限公司

Binzhou DONGLI Stainless Steel Products Co.,Ltd.

 0086-543-6421581 0086-543-6427550

 China · shandong wudi

 amy@cndongliss.com

 <http://www.cndongliss.com>



DONGLI

THE ENVIRONMENTAL
AND PROTECTION IS THE
PROBLEM OF THE WORLD, START FROM US

DONGLI

Camlock Couplings/Pipe Fitting/Ball Valve



滨州东利金属科技股份有限公司

Binzhou DONGLI Stainless Steel Products Co.,Ltd.



公司简介 ABOUT

COMPANY INTRODUCTION DONGLI CASTING



Binzhou Dongli Stainless Steel Products Co., LTD is a comprehensive enterprise specializing in the production, processing and surface treatment of stainless steel precision castings. Our main products are (include) Camlock couplings, threaded pipe fittings, auto parts, ball valves, rigging and various kinds of industrial coupling and accessories. Our company was founded in 2010 and has more than 130 employees, with an annual capacity of 1,200 tons of high-quality castings. The products are widely used in fire fighting, construction, fluid pipeline, Marine hardware, aerospace, auto industries, medical instruments, petrochemical and other fields.

We ensure the perfect interior and exterior quality with the silicasol lost wax casting technology, high precision CNC lathe, and equipped with advanced spectrometer, sclerometer, metallographic microscope and other equipment. The products can be produce by the material stainless steel 304/316/304L/316L/201, plain carbon steels, structural alloy steel, aluminum alloy, brass and so on. The products was exported to Europe, America, Australia, Russia, Korea, Japan and other countries and regions, received good appraises both at home and abroad.

Our company has a professional professional R&D team and complete quality control capabilities. We can also provide drawings, tooling design, mold design and development and other technical support according to customer requirement. Pre-furnace spectrum analysis, casting mechanical property testing, nondestructive testing, heat treatment hardness testing, metallographic analysis, 3D coordinate measurement of workpiece and other monitoring methods provide necessary hardware support for ensuring product quality. At the same time, the company also established a perfect quality control system, and passed ISO9001:2015 quality management system certification, TS16949:2016 quality system certification.

Our company adhering to the concept of "quality first, customer first", to meet customer needs as the goal, dedicated to the majority of customers to do a good job in service. Sincerely welcome your visit, guidance and business negotiation. Dongli Steel is looking forward to working with you to create brilliant!

滨州东利金属科技股份有限公司是一家专业从事不锈钢精密铸件生产，深加工及铸件表面处理的综合性企业，主要产品有快速接头、螺纹管件、汽车配件、球阀、索具等各种工业接口和配件。公司成立于2010年，目前拥有员工130余人，年生产规模超过1200吨。产品广泛应用于消防、建筑、流体管道、船用五金、航空航天、医疗器械、石油化工等领域。

我公司采用硅溶胶失蜡铸造工艺生产精密铸件，配备高精度CNC数控车床、加工中心进行深加工。材质涉及到不锈钢（316、316L、304、304L），普通碳钢，合金结构钢，铝合金，黄铜等。产品畅销于美国、澳大利亚、俄罗斯、德国、韩国、日本等国家和地区。

公司拥有专业的产品研发团队和完备的质量控制能力，可根据客户提供产品图纸、工装设计，模具设计开发等方面的技术支持。炉前光谱分析，铸件机械性能检测，产品无损探伤，热处理硬度检测，金相分析，加工件三维坐标测量等监控手段为确保产品质量提供了必要的硬件支持。同时，公司还建立了完善的质量监控体系，并通过了质量管理体系ISO9001:2015，TS16949:2016的质量体系认证。

公司秉承质量至上，客户至上的理念，以满足客户需求作为目标，竭诚为广大客户做好服务。真诚欢迎您莅临参观指导和业务洽谈。东利金属期待与您携手共创辉煌！

PRODUCTION PROCESS

生产工艺

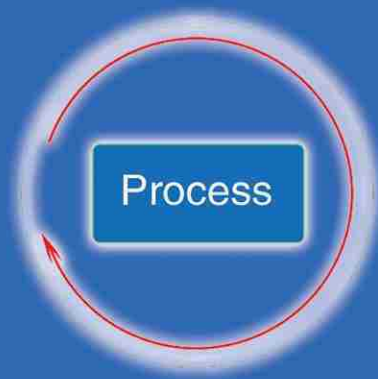

01 Mould Making

02 Wax Injectin

03 Pattern Assembly

04 Shelling

05 Dewaxing

06 Burning

07 Pouring

08 Shell Removing

09 Cutting

10 Ingate Removing



DONGLI strictly control every details of production, including the purchase of raw materials, design, shellmaking, casting, CNC processing. The whole process takes inspection with many times to ensure the highquality. DONGLI has established a quality-first management team.

东利精密铸造严格控制生产的每一个环节，从原材料采购、设计、制壳、浇铸、数控加工，全过程的反复检验，以确保产品的高品质，从而建立了一支以品质为先的管理队伍。



Type A
Camlock Coupling



Type B
Camlock Coupling



Type C
Camlock Coupling



Type D
Camlock Coupling



Type E
Camlock Coupling



Type F
Camlock Coupling



Type DC
Camlock Coupling



Type DP
Camlock Coupling



Type SC
Camlock Coupling



Type SE
Camlock Coupling



Type AF
DIN Camlock Coupling



Type CC
DIN Camlock Coupling



Type DF
DIN Camlock Coupling



Type EC
DIN Camlock Coupling



Type SC
DIN Camlock Coupling



Type SE
DIN Camlock Coupling



Type B
Autolock Camlock Coupling



Type C
Autolock Camlock Coupling



Type D
Autolock Camlock Coupling



Type DC
Autolock Camlock Coupling



Type AA
Camlock Coupling



Type DD
Camlock Coupling



Type DA
Camlock Coupling



Type 90° C
Camlock Coupling



FA&FC
Camlock Coupling



Safe Clamps



GI with smooth tail



GI with serrated tail



GA with smooth tail



GA with serrated tail



Gasket



Handles



90° Elbow F-F



Reducing Elbow F-F



45° Elbow F-F



90° Street Elbow F-M



TEE F-F-F



Reducing Tee F-F-F



Tee M-M-M



45° TEE F-F-F



Tee Type-Y



Reducing Cross



Reducing Socket



Hex Nipple M-M



Reducing Hex Nipple



Union F-F



Union F-M



Union M-M



Union Elbow F-F



Union Elbow F-M



Butt Welded Union



Union BW-F



Square Plug M



Hex Plug M



Hex Bushing M-F



Round Cap F



Hex Cap F



Hex Adaptor F-M



Negative Hex Bushing



Round Adaptor



Socket Banded



Hose Nipple M



Hose Nipple F



Hex Nut F



Half Nipple



Barrel Nipple



Coupling



Shackle



Eye Nut



Eye&Eye End Swivel



Turnbuckle



Automatic drain valve



1-PC Ball Valve



2-PC Ball Valve



3-PC Ball Valve



Swing Check Valve



Y Type strainer

备注:

- 1.以上产品为公司标准铸件，并备有现货库存，尺寸齐全。
- 2.接受客户开模定制，我司可提供画图 and 打样。
- 3.材质保证，SS304 (CF8) 和SS316 (CF8M) 为常规材质。
- 4.多种螺纹可选，如BSPT, BSP, NPT, G等等。

Note :

- 1.The above products are the standard casting fittings in our warehouse. We have large stock and full size.
- 2.OEM is acceptable. Our design department can provide drawing and sample service.
- 3.Material is promised. SS304 (CF8) and SS316 (CF8M) are available.
- 4.Various thread type for your selection, such as SPT,BSP, NPT, G, etc..

DONGLI

炼百年不锈钢 铸绿色未来

Smelting century stainless Casting a green future

滨州东利金属科技股份有限公司
Binzhou DONGLI Stainless Steel Products Co.,Ltd.

 0086-543-6421581 0086-543-6427550

 China • shandong wudi

 amy@cndongliss.com

 <http://www.cndongliss.com>



DONGLI

THE ENVIRONMENTAL
AND PROTECTION IS THE
PROBLEM OF THE WORLD, START FROM US